

FOR LEASE: Office Space

261 Montreal Road, Ottawa, ON



DESCRIPTION:

- ✓ Beautifully renovated freestanding Commercial Office Building with Adjacent Parking Lot located on the north side of Montreal Road close to the centre of Vanier, in the east end of Ottawa.
- ✓ Surrounded by well established businesses with older residential to the north and the east of the building. Many new developments planned for this part of Montreal Road.
- ✓ This location has good visibility along Montreal Road, with high volume of traffic. Easy access to Vanier Parkway, major transit routes and close to new LRT station. Minutes away from downtown Ottawa.

Basement Office Space Available Immediately:

- ✓ Studio space A3: Approximately 716.42 square feet rentable.
- ✓ Skelton HD space: Approximately 1,084.87 square feet rentable.
- ✓ Gross Rental Rate: \$15.00 per square foot per annum gross. All inclusive including utilities.

OFFICE SPACE AVAILABLE FOR LEASE:

Above-Ground Office Space Potentially Available:

- ✓ Up to 4,400 square feet rentable.
- ✓ Potentially available Fall, 2022. Call for details.
- ✓ Minimum Net Rent: \$15.00 per square foot net per annum.
- ✓ Additional Rent: \$13.00 per square foot per annum (estimate).

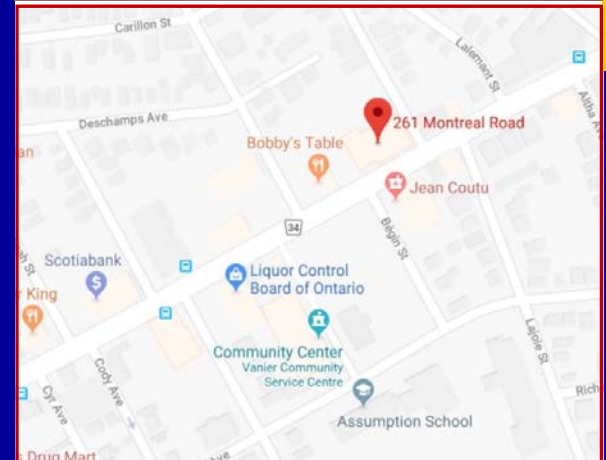

For more information please contact:

BRENT TAYLOR, Broker of Record / President
BRENTCOM REALTY CORPORATION, BROKERAGE
Tel: (613)726-7323 Fax: (613)721-8849
Email: brent@brentcomrealty.com
www.brentcomrealty.com

The information as herewith enclosed has been obtained from sources we believe to be reliable, but we make no representation or warranties, express or implied, as to the accuracy of the information. All references to age, square footage, income, expenses, data and other information contained herein are approximate and subject to change. Prospective purchasers or tenants shall not construe the information as legal or tax advice. Buyers or tenants should conduct their own independent investigations and rely only on those results. All properties subject to change or withdrawal without notice. E. & O. E.

FOR LEASE: Office Space

261 Montreal Road, Ottawa, ON



- Tenant Area
- Tenant Ancillary Area
- Rentable Exclusions
- Floor Service Area
- Building Service Area
- Building Amenity Area
- Inter-Building Service Area
- Inter-Building Amenity Area

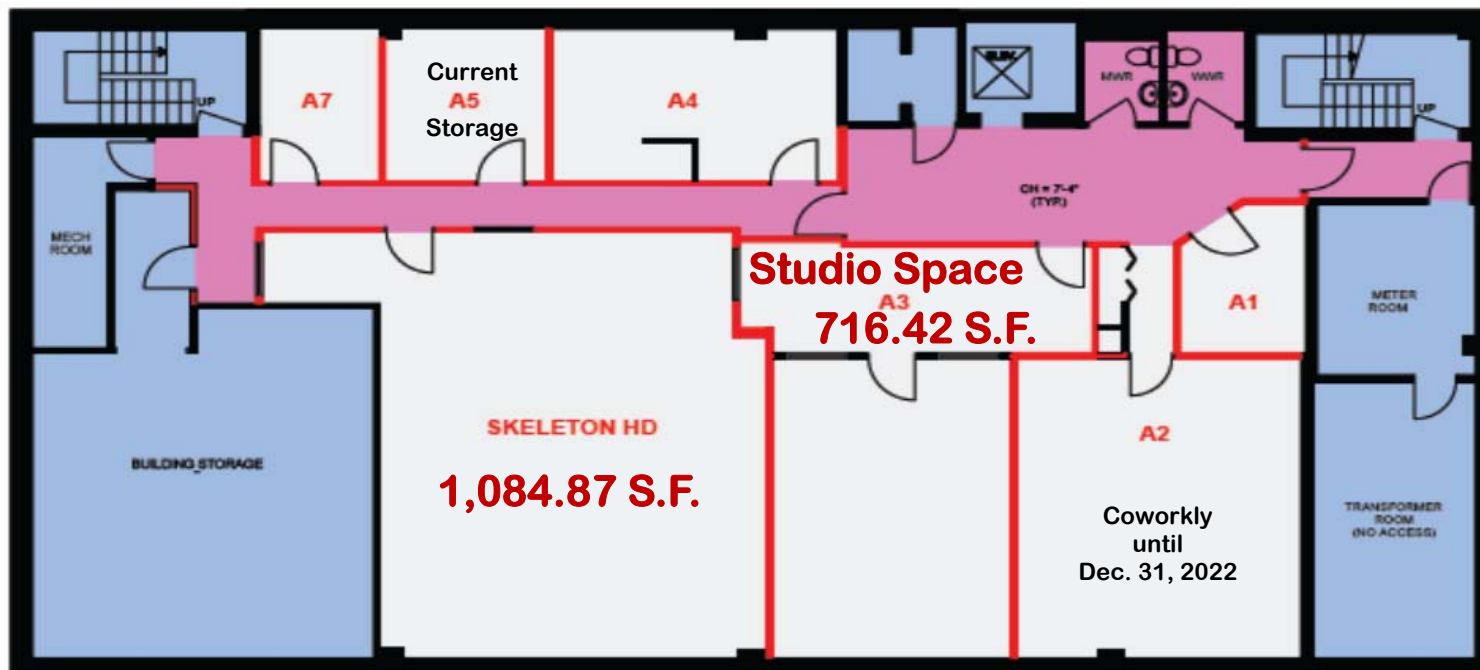

The information as herewith enclosed has been obtained from sources we believe to be reliable, but we make no representation or warranties, express or implied, as to the accuracy of the information. All references to age, square footage, income, expenses, data and other information contained herein are approximate and subject to change. Prospective purchasers or tenants shall not construe the information as legal or tax advice. Buyers or tenants should conduct their own independent investigations and rely only on those results. All properties subject to change or withdrawal without notice. E. & O. E.

FOR LEASE: Office Space

261 Montreal Road, Ottawa, ON

BRENTCOM
REALTY CORPORATION, BROKERAGE
COMMERCIAL SALES • COMMERCIAL LEASING • CONSULTING



The information as herewith enclosed has been obtained from sources we believe to be reliable, but we make no representation or warranties, express or implied, as to the accuracy of the information. All references to age, square footage, income, expenses, data and other information contained herein are approximate and subject to change. Prospective purchasers or tenants shall not construe the information as legal or tax advice. Buyers or tenants should conduct their own independent investigations and rely only on those results. All properties subject to change or withdrawal without notice. E. & O. E.